

Installation Kit Components

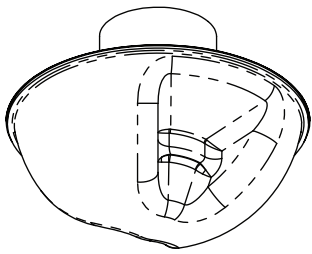

FresherVent

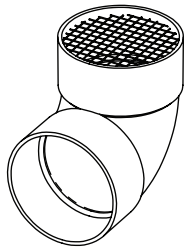

Screened Elbow

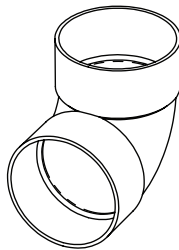

Elbow

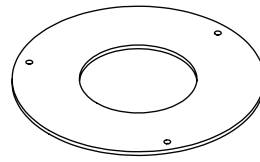

Trim Ring (2x)

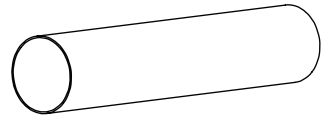

Pipe

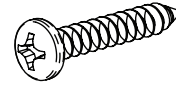

Screw (6x)

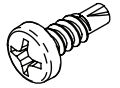

Drilling Screw (3x)

Tools Required



Drill



Drill Bit



Phillips Bit

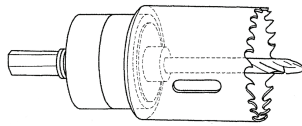

3 1/4" Hole Saw



Knife (to cut wall insulation)

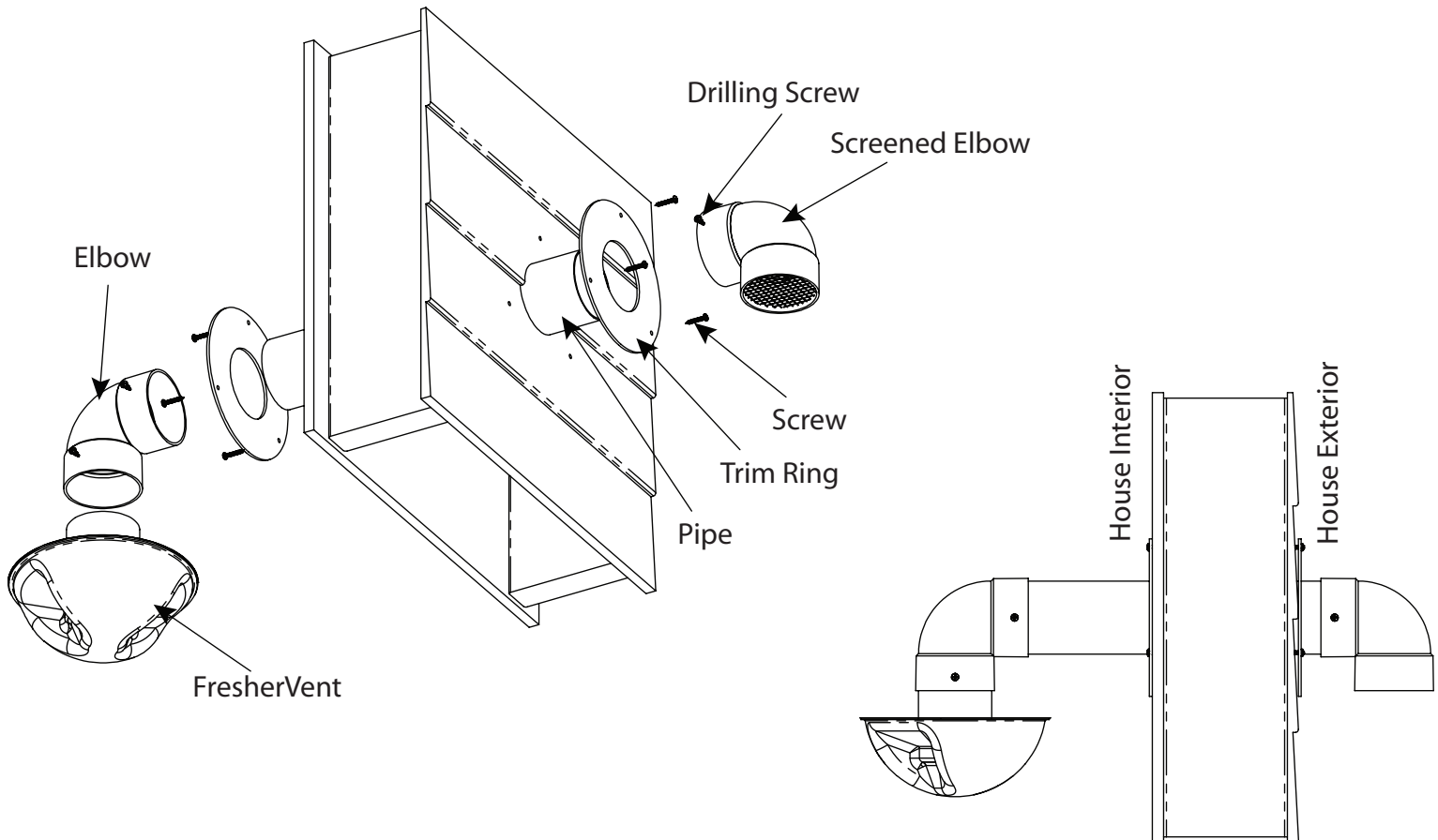

Installation Complete

Installation Instructions:

* Location on structure: **Avoid locations affected by prevailing winds.**

Air intake separation distance from exhaust and other features are specified in table 5.5.1 of the document 62_1_2016_r_20181030.pdf located at the website <https://www.ashrae.org/>

1. Cut hole in wall between studs with 3-1/4" hole saw. Figure A
* **Beware of electrical wiring in walls!** *
2. Insert Pipe (cut to length if desired). Figure B
3. Slide Trim Ring over outdoor end of Pipe and fasten with Screws. Figure B
4. Slide Screened Elbow onto Pipe, fasten with Drilling Screw. Figure C
5. Slide Trim Ring over indoor end of Pipe, fasten with Screws. Figure D
6. Slide remaining Elbow on indoor end of Pipe, fasten with Drilling Screw. Figure E
7. Insert FresherVent into Elbow, fasten with Drilling Screw. Figure F

